

Gorings Mead, Horsham

Offers Over £375,000

 3  1  2



An attractive bay fronted Period Property located in Central Horsham boasting Two Reception Rooms, a generous Rear Garden and a 9'10 x 9'10 Home Office.

Tenure: Freehold

Council Tax: C

EPC: Current D - Potential B

Key Features

- Attractive Period Property
- Three Bedrooms
- Modern Family Bathroom
- Two Separate Reception Rooms
- 0.3 Miles From Horsham Town Centre
- 0.5 Miles From Horsham Station
- 9'10 x 9'10 Home Office/Cabin
- Ideal Location For Commuters
- Popular School Catchment
- Close To Countryside Walks

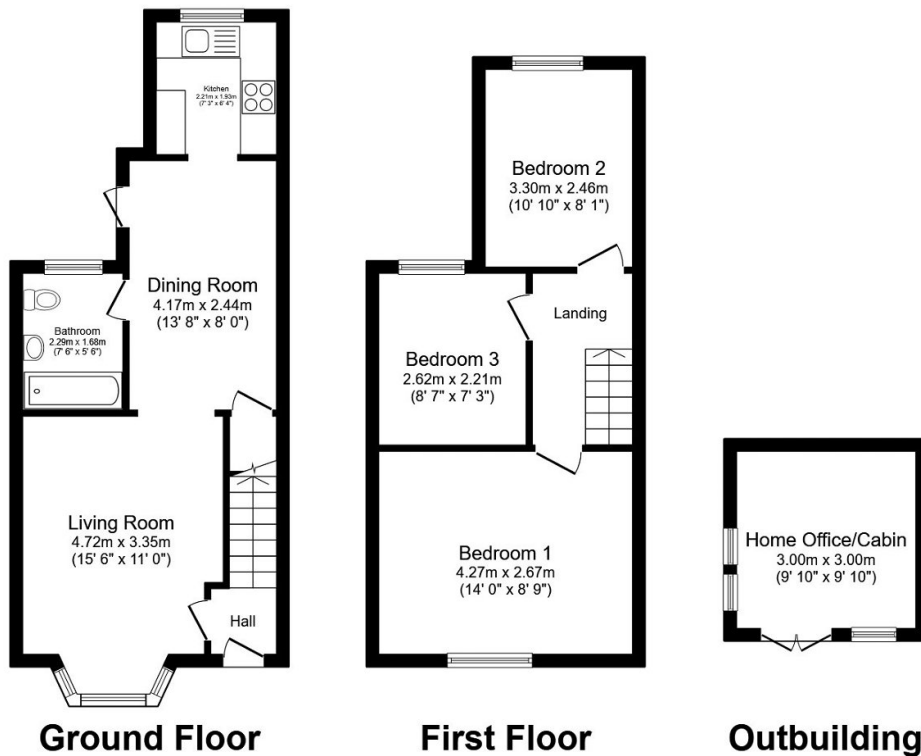

Total floor area 81.5 sq.m. (877 sq.ft.) approx

This plan is for illustration purposes only and may not be representative of the property. Plan not to scale. Powered by PropertyBox